



OZARK PATIO COVER ASSEMBLY INSTRUCTIONS



Recommended Tools:

Level, Pliers, 3/8" Electric Drill, Carpenters Square, Tape Measure, Metal Hack Saw, Silicone Caulking, Screw Drivers (Regular & Phillips)

Before You Begin:

- 1.) Please read all instructions carefully. Check the Bill of Materials for any missing parts, and gather all necessary tools. The paint finish can be scratched so place materials on tarp or cardboard to prevent scratching.
- 2.) Note that this patio cover kit is not designed to carry additional loads such as hanging plants, swings, people, trellis's, or other objects.

OZARK PATIO COVER PARTS LIST

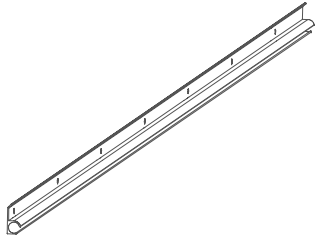

1. Awning Rail

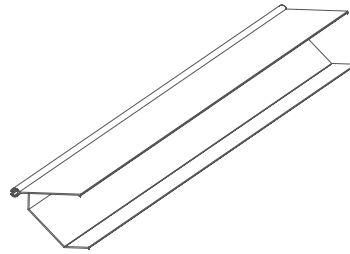

2. Wall Mtg. Channel

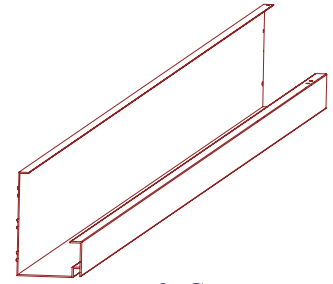

3. Gutter

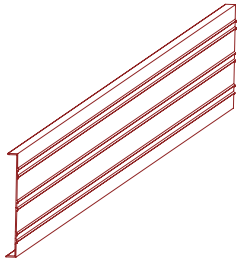

4. Fascia

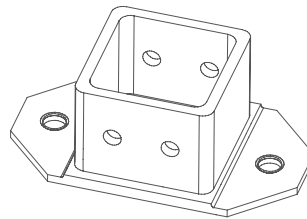

5. Lower 1 1/2" Sq. Post Bracket



6. Corner Cap

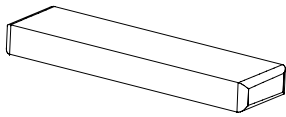

7. Styrofoam Flashing Plug

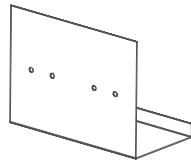

8. Gutter Splice (Optional)

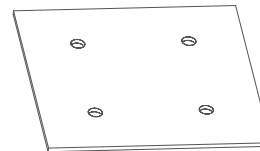

9. Wall Channel Splice Plate (Optional)

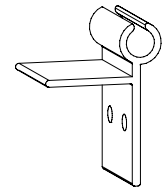

10. Upper 1 1/2" Sq. Post Bracket

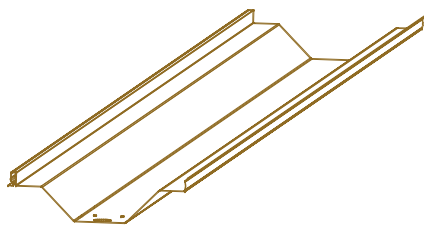

11. Roof Panel

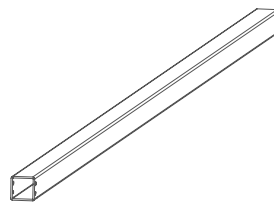

12. 1 1/2" x 1 1/2" Post

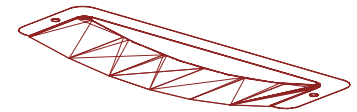

13. Scupper

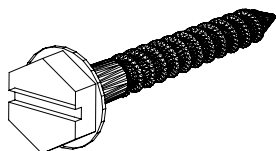

14. 1 1/2" Lag Screw

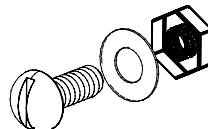

15. #8 - 32 x 1/2"
Bolt, Nut, & Washer

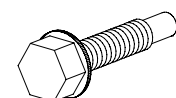

16. #8 x 3/4" Tek Screw

STEP 1.

Drill 1/4" dia. holes beginning 2" from either end at 12" to 16" on center in awning rail as shown (see Fig. 1-1). Slide awning rail onto wall Channel and apply a generous bead of silicone to backside of awning rail (see Fig 1-2). (NOTE: Center to center dimension of 1/4" holes is determined by location of walls studs or other structural member that the awning must be anchored to. Do Not attach awning to sheeting, siding, flashing, or any other non-structural surface.)

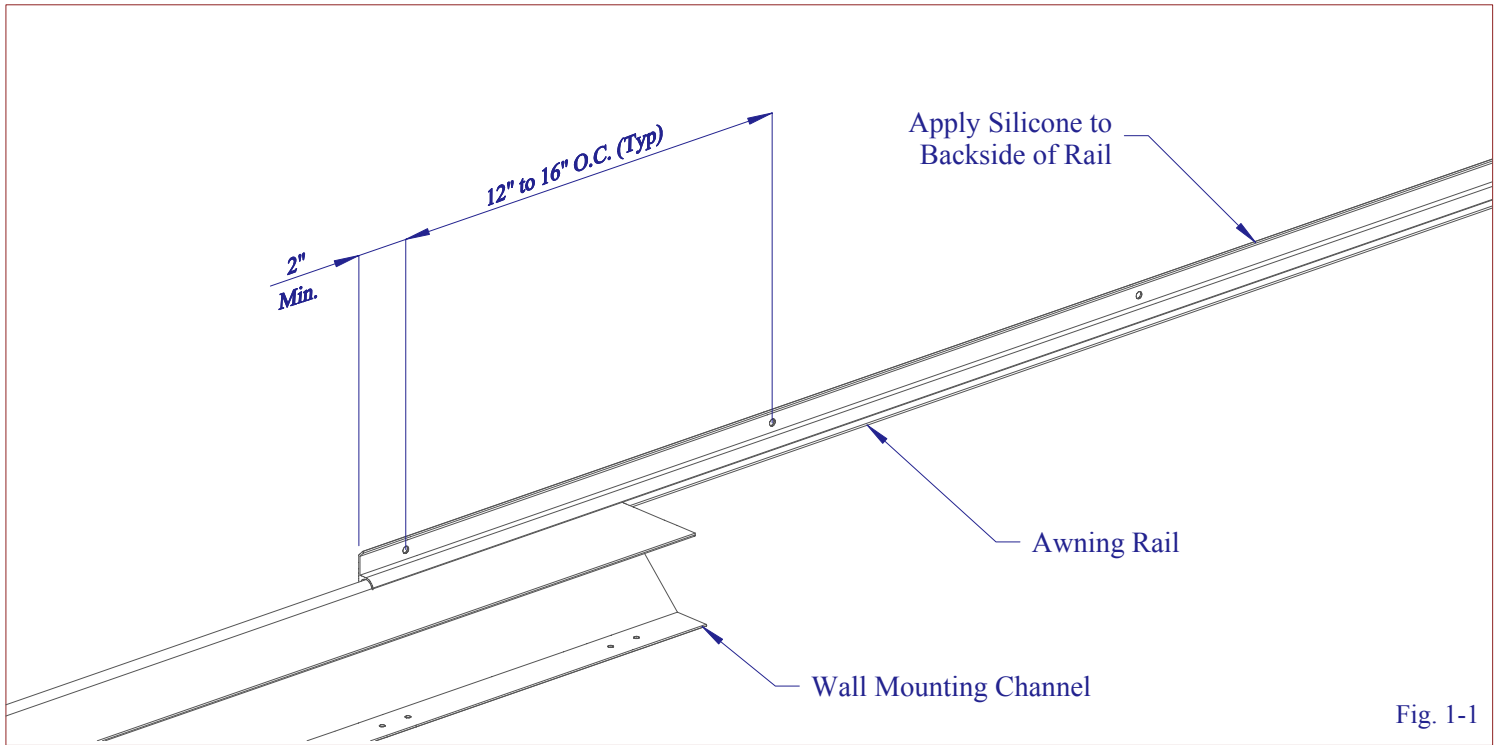

Mark a level line approximately 5 1/2" above out-swinging door. Align holes in awning rail with level line, and attach awning rail / mounting channel assy. to existing structure with 1 1/2" lag screws (see Fig. 1-3). If mounting channel is in two sections a splice plate is required (see Fig. 1-4). Be sure to caulk wall mounting channel at splice and remove excess silicone after attaching.

NOTE: If attaching patio cover to concrete or masonry unit a masonry drill, bit, and anchors are required.

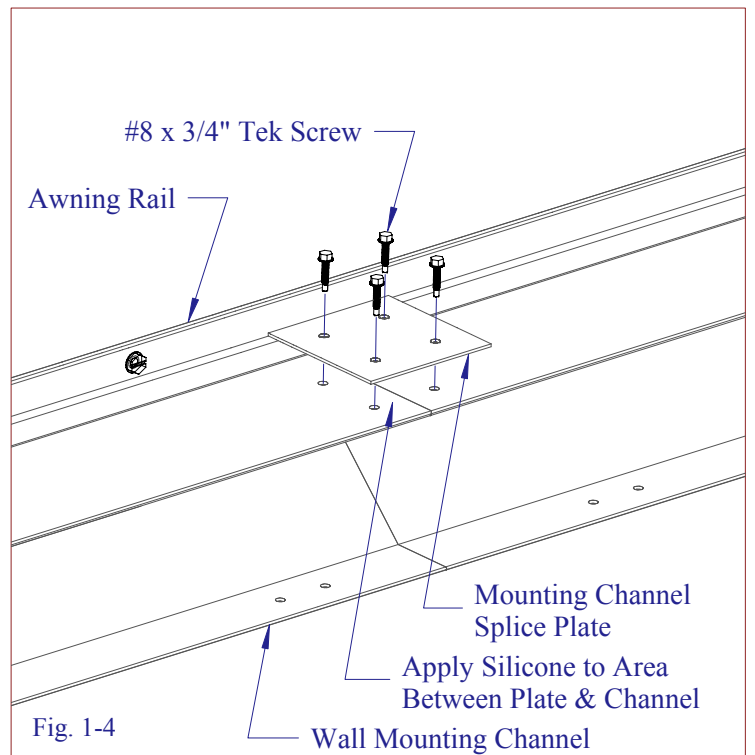
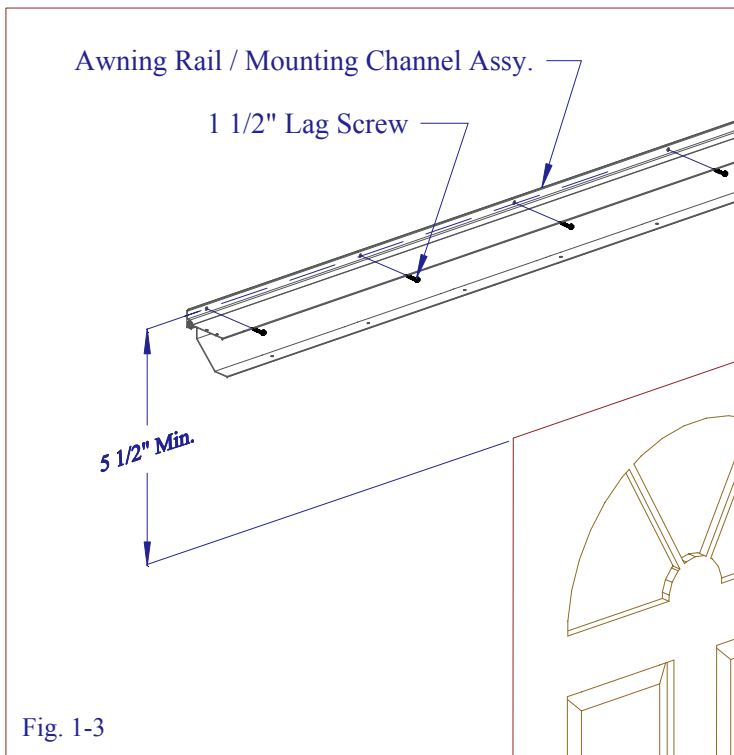

STEP 2.

If the Gutter is in two sections insert the gutter splice, caulk, and fasten with #8 Tek Screws as shown (see Fig 2-1). Longer models with numerous gutter sections require splicing after attaching post and standing upright. Attach post bracket to top of post using 2 - #8 x 3/4" Tek screws (see Fig 2-2).

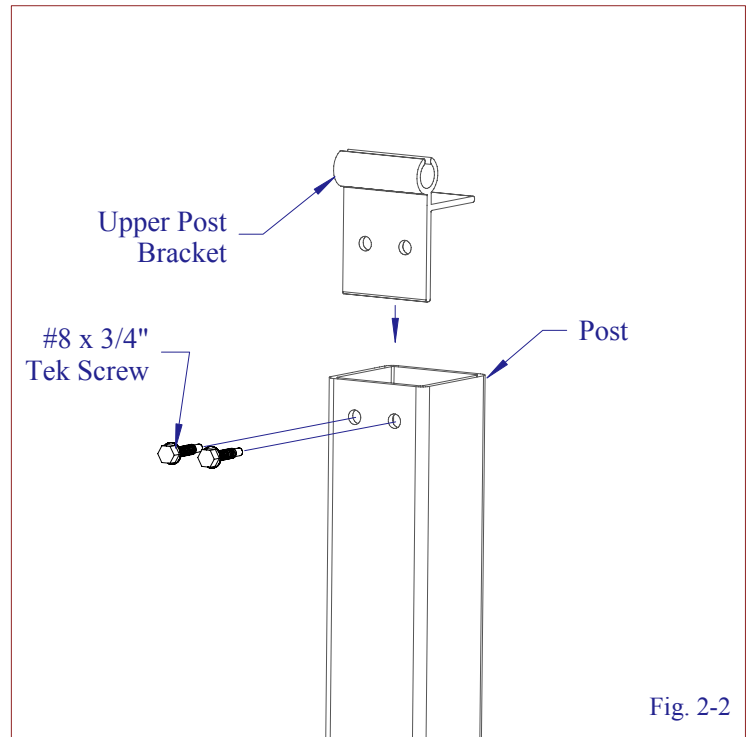
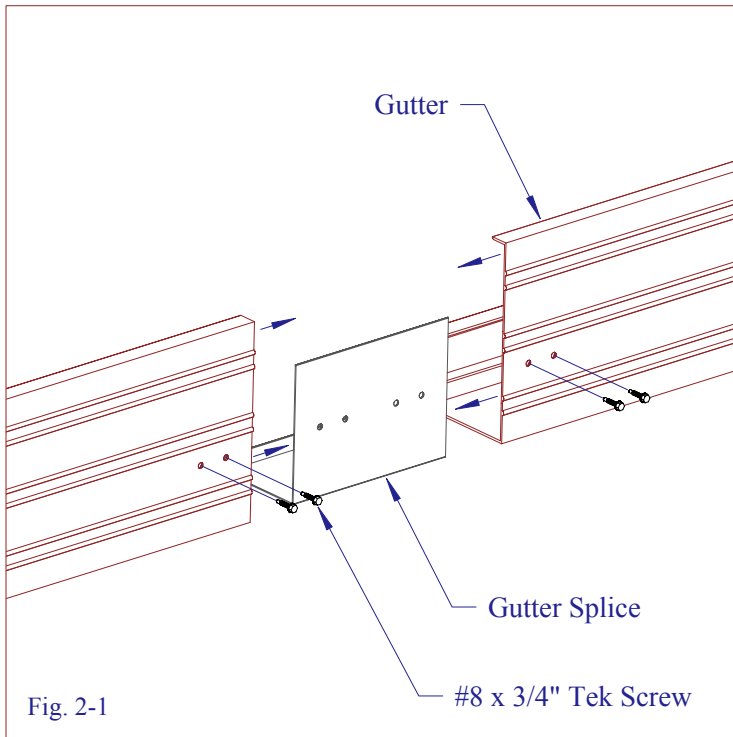

Cut posts to proper length, we recommend the front height of cover be 1/2" per foot of projection lower than mounting height. (EX: With a 8'-0" projection the front height should be 4" lower than mounting height. see Fig 2-3) Slide post & bracket into bottom side of gutter and arranging post approximately 12" from ends of gutter (see Fig. 2-4). Stand the gutter / post assy. upright. Upright assembly can be used to temporarily support the front of deck panels (see Fig. 3-1).

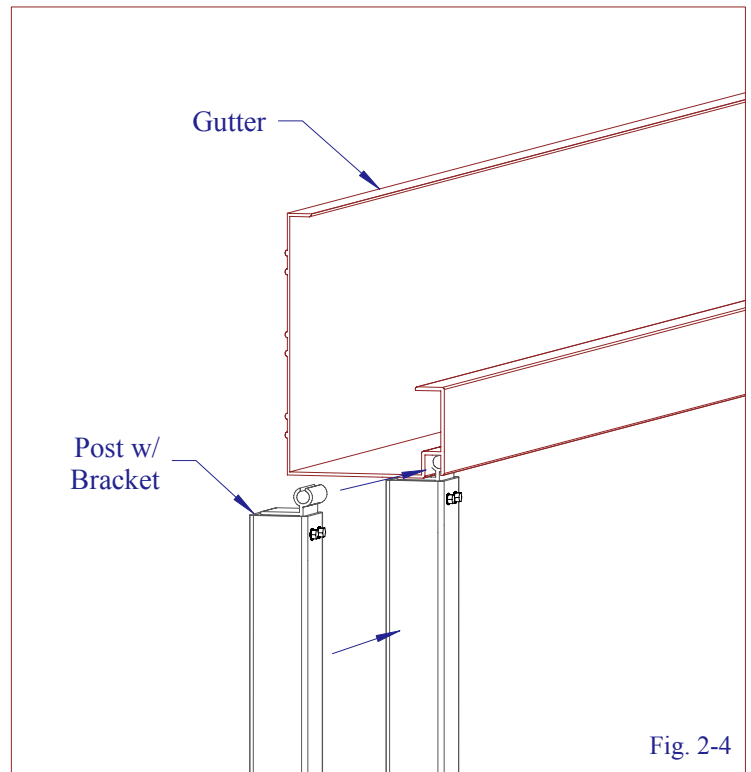
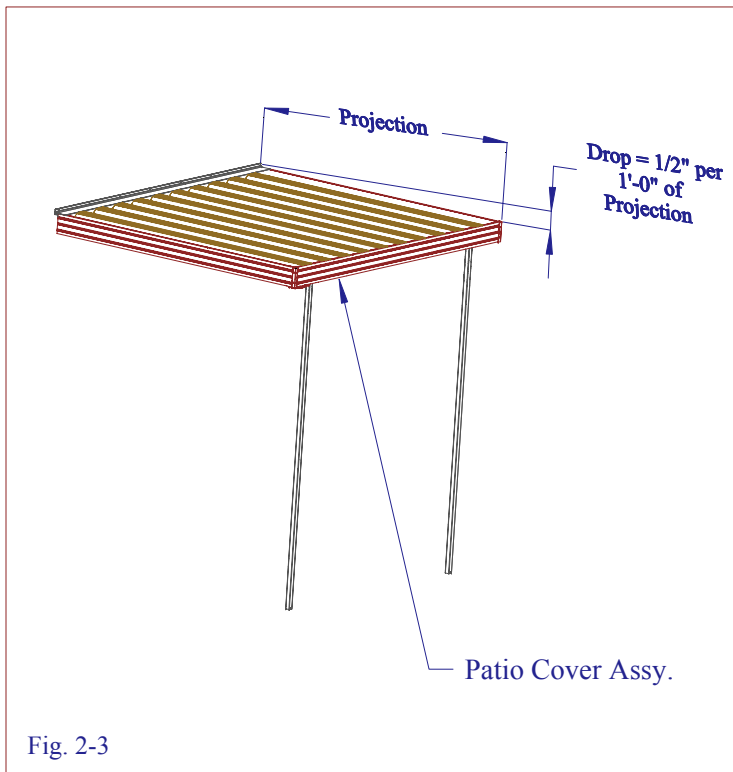

STEP 3.

The post-gutter assembly can be used to support the front half of the roof panels while the rear half is attached to the mounting channel (see Fig. 3-1). Do Not secure front half of roof panels to gutter until all roof panels are attached to mounting channel. Attach one end of the roof panel to the wall channel using 1 - #8 - 32 x 1/2" bolt w/ nut & washer. After roof panel is secure apply silicone to four faces of the styrofoam flashing plug & fit it between mounting channel and roof panel (see Fig 3-2).

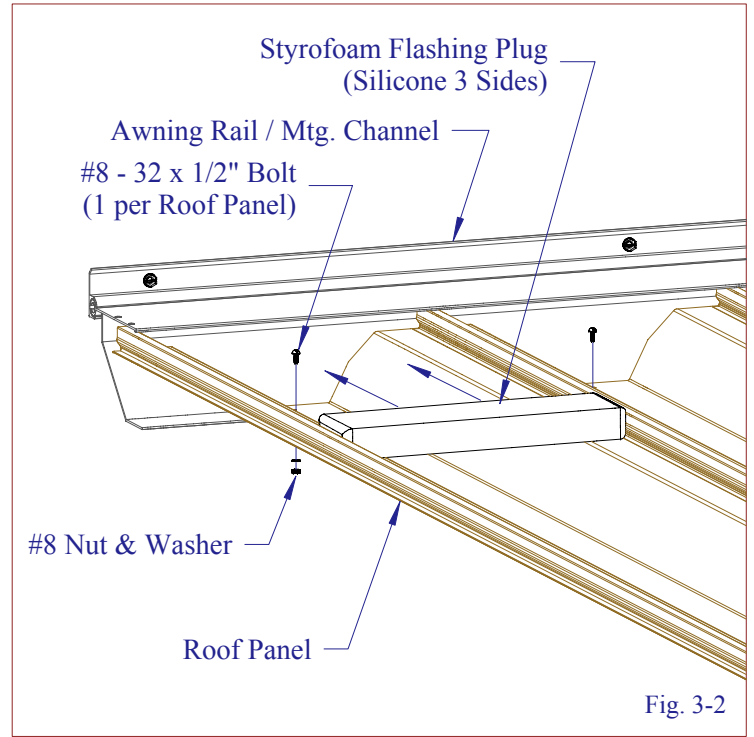
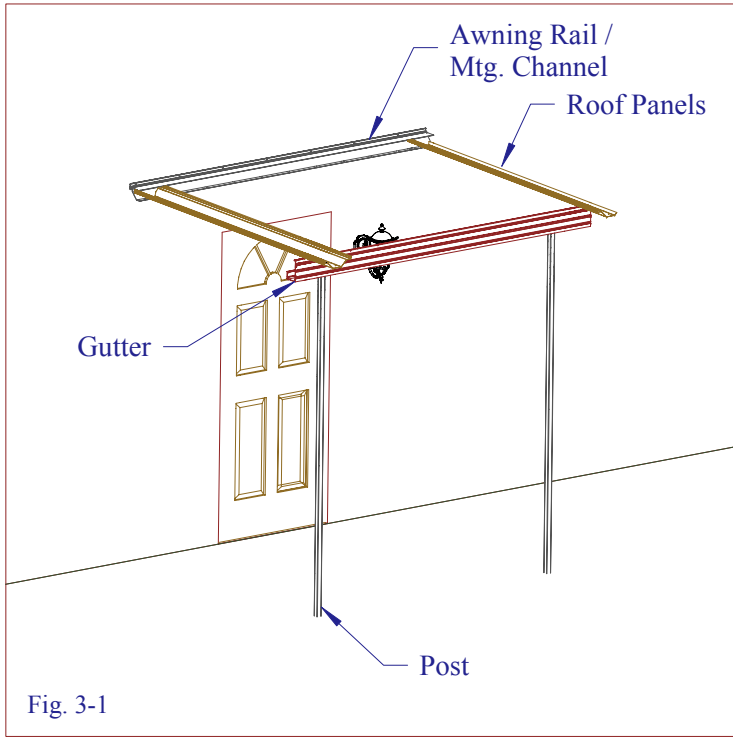

Once roof panels are secure to mounting channel, move the gutter-post assembly to front of roof panels. Square the entire unit. Connect roof panels to gutter using 2 - #8 x 3/4" Tek screw per panel as shown (see Fig. 3-4). Square the roof panels to the gutter / wall channel once more before tightening all screws.

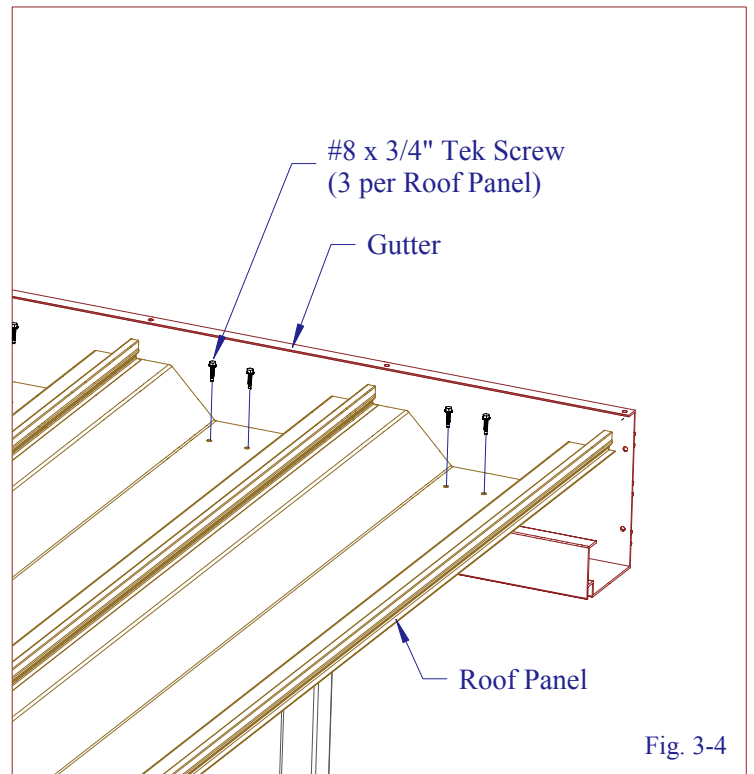
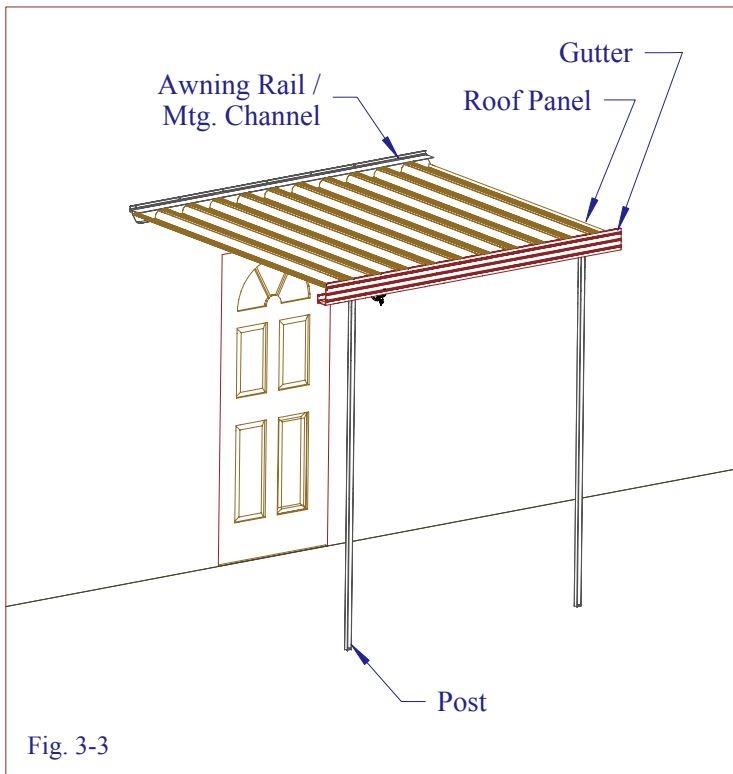

STEP 4.

Attach one end of projection fascia to the wall channel with 2 - #8 x 3/4" screws from the top of fascia. If your patio cover has a projection greater than 8'-0" we recommend securing the center of the fascia to the roofing panel as shown (see Fig. 4-1). Attach the either end of projection fascia to the gutter by caulking & installing corner caps with #8 x 3/4" screws (see Fig. 4-3).

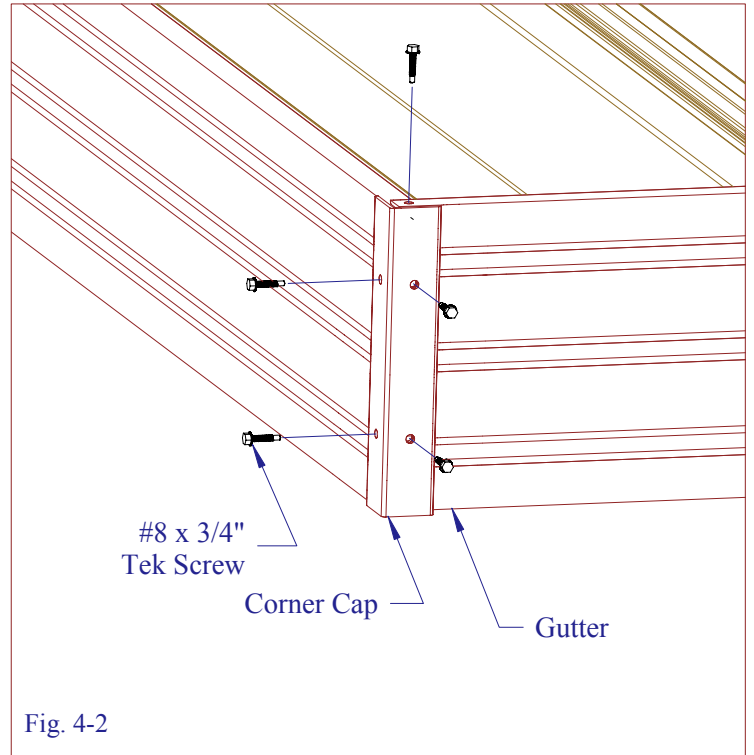
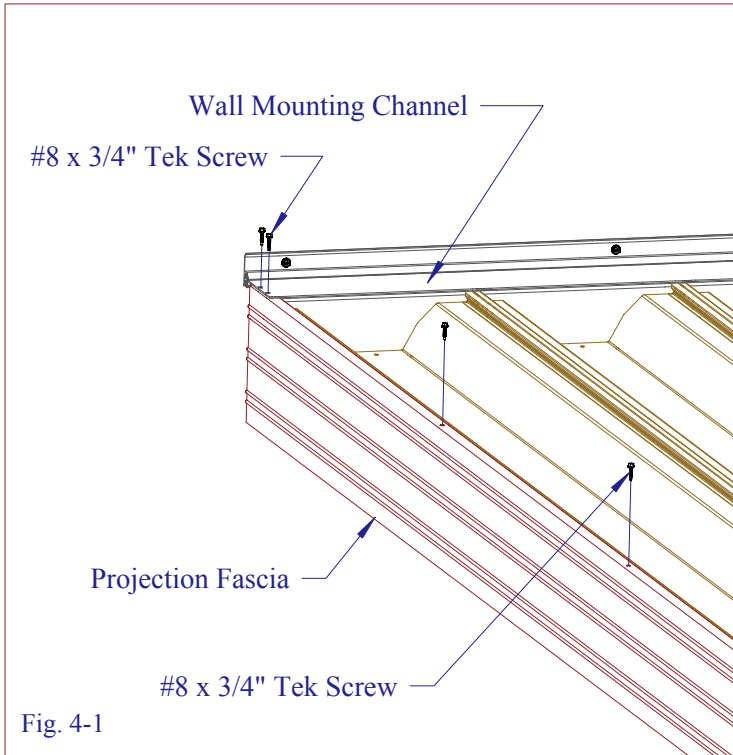

STEP 5.

Determine where you want the water to run from unit. Mark and drill several small holes in bottom of gutter forming a pattern no bigger than 2" x 3". Apply silicone to flange of scupper & attach to gutter with 2 - #8 x 3/4" Tek screws covering holes (see Fig. 5-1).

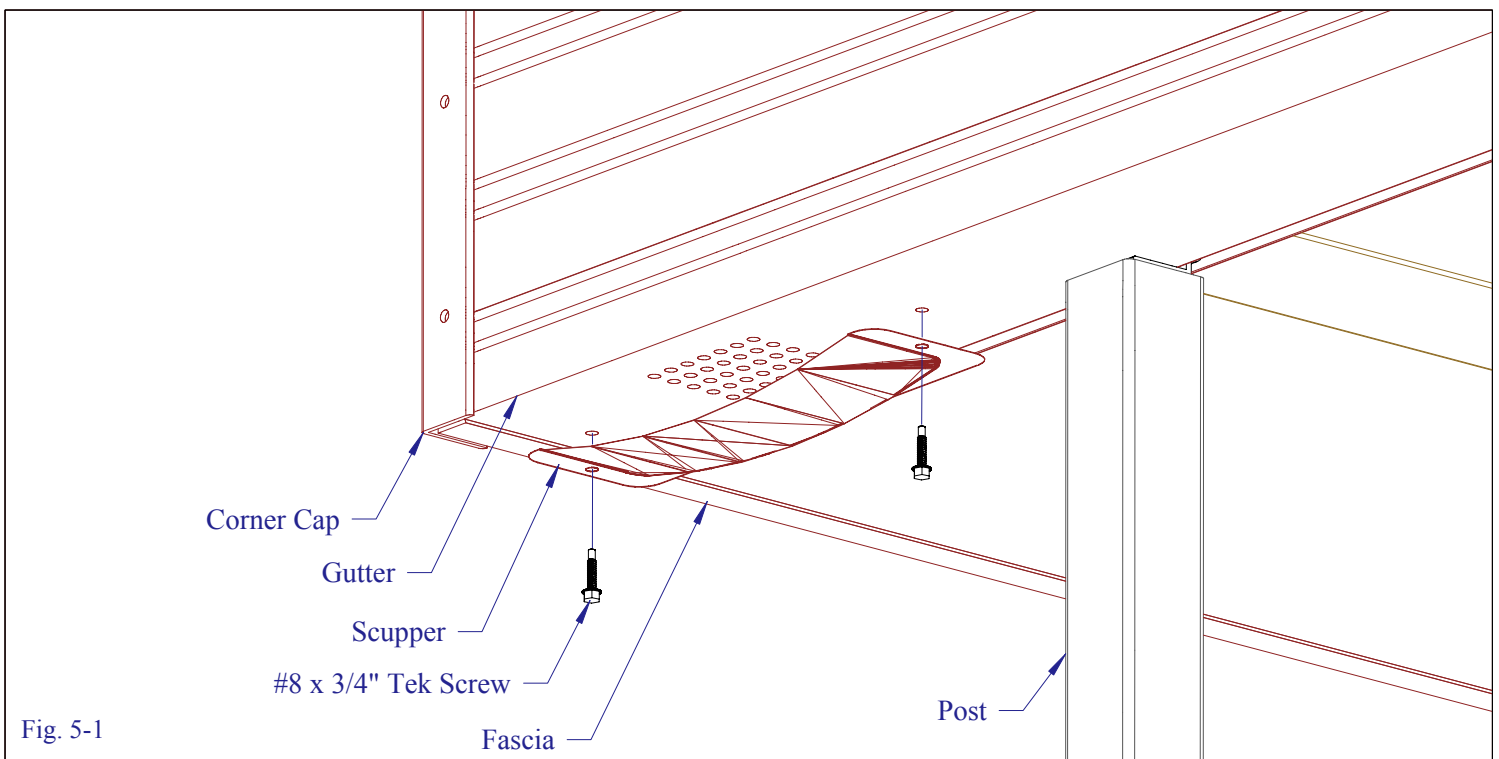

STEP 6.

Attach bottom post bracket to deck or slab directly beneath the gutter-to-post connection using 2 - 1 1/2" screws or concrete anchors per bracket. Secure post brackets using 4 - #8 x 3/4" Tek screws (see Fig 6-2).
NOTE: Be sure to square post brackets with building and post spacing (see Fig. 6-1).

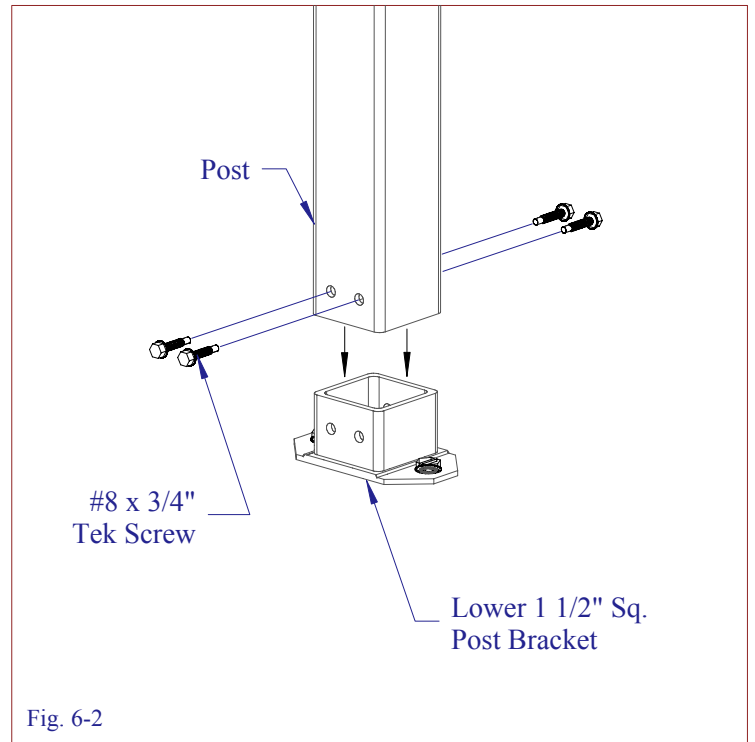
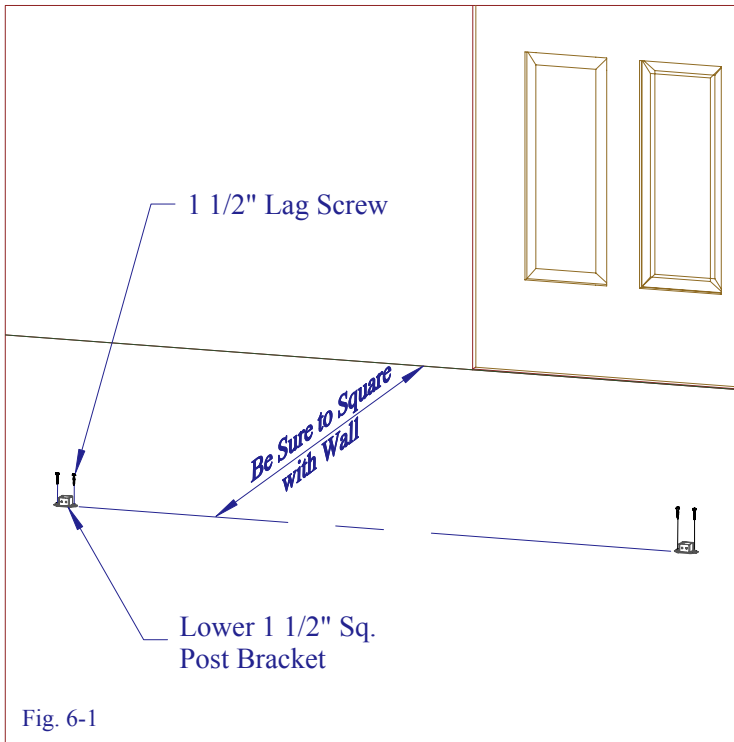

OPTIONAL DOWNSPOUT ASSEMBLY

Cut hole in desired location along front gutter. We recommend the hole be located beside a post. Using #8 x 3/4" screws attach downspout flange over hole, be sure to apply silicone between flange and gutter (see Fig. DS-1). Cut downspout tube to desired length and secure to neck of downspout flange with #8 x 3/4" Tek Screw.

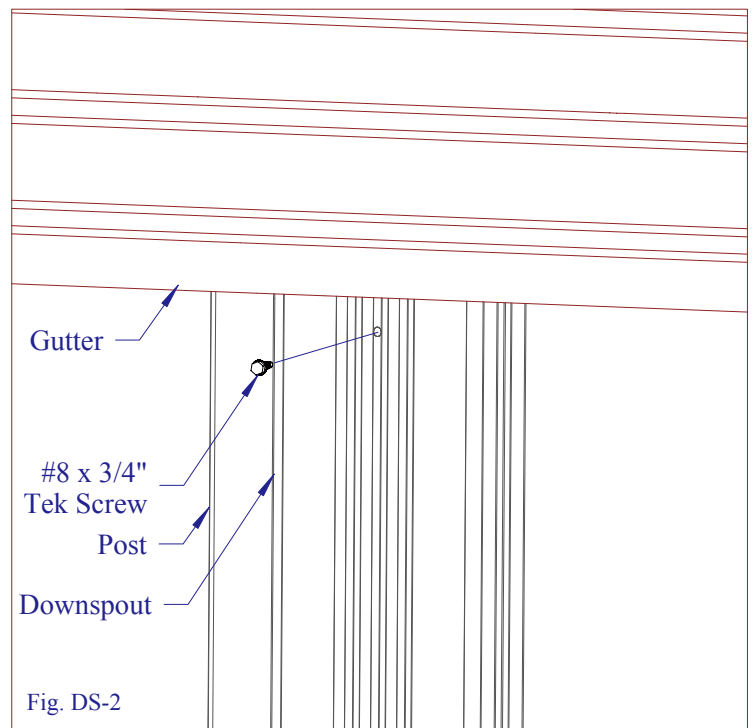
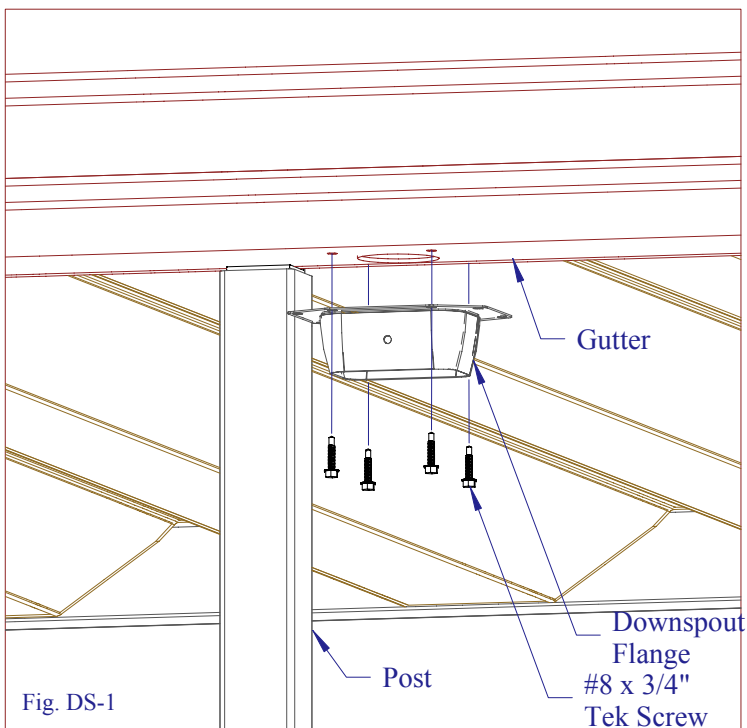

OPTIONAL DOWNSPOUT ASSY. CONT.....

Strap downspout tube to post using 3 - #8 x 3/4" Tek screw per strap (see Fig. DS-3). Attach downspout elbow to tube w/ #8 x 3/4" Tek screw. (NOTE: Insert bottom of tube into elbow for effective water flow.) Use the remainder of downspout tube attaching it to the bottom of elbow as shown (see Fig. DS-4).

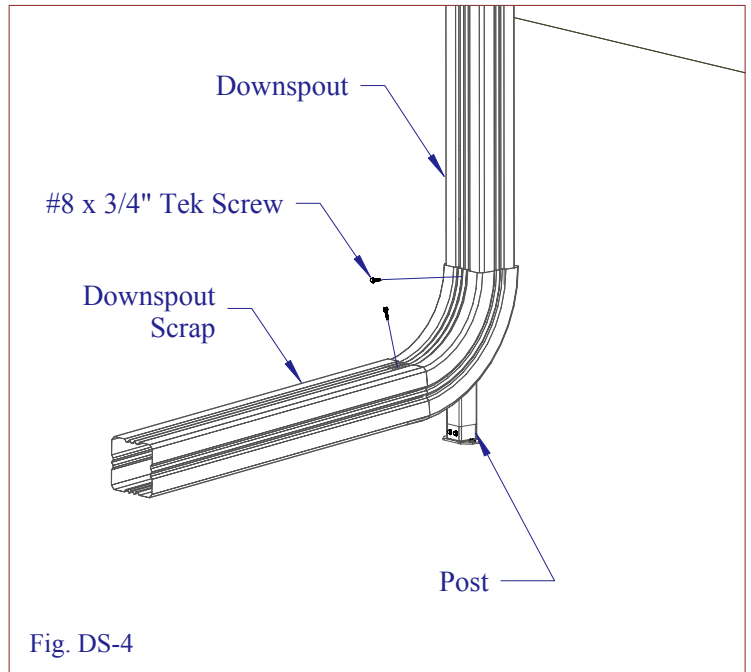
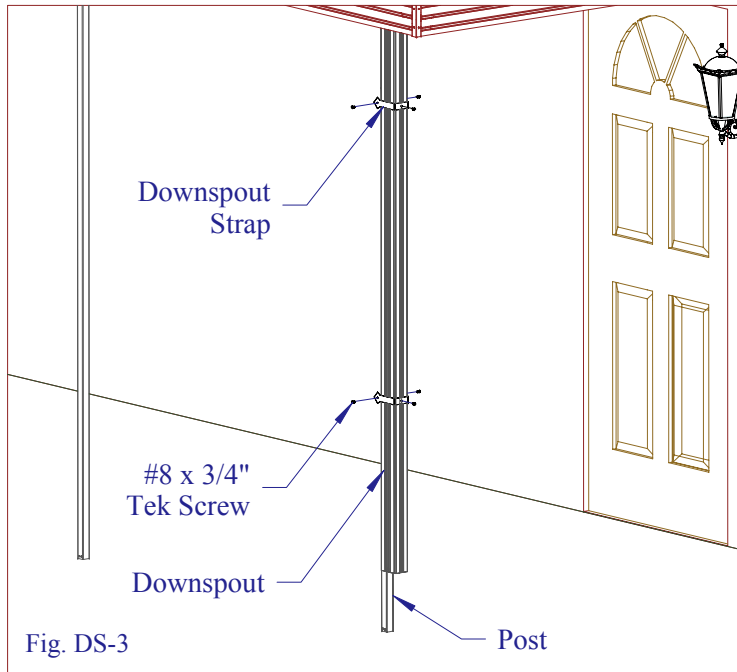

ASSEMBLY COMPLETED

