

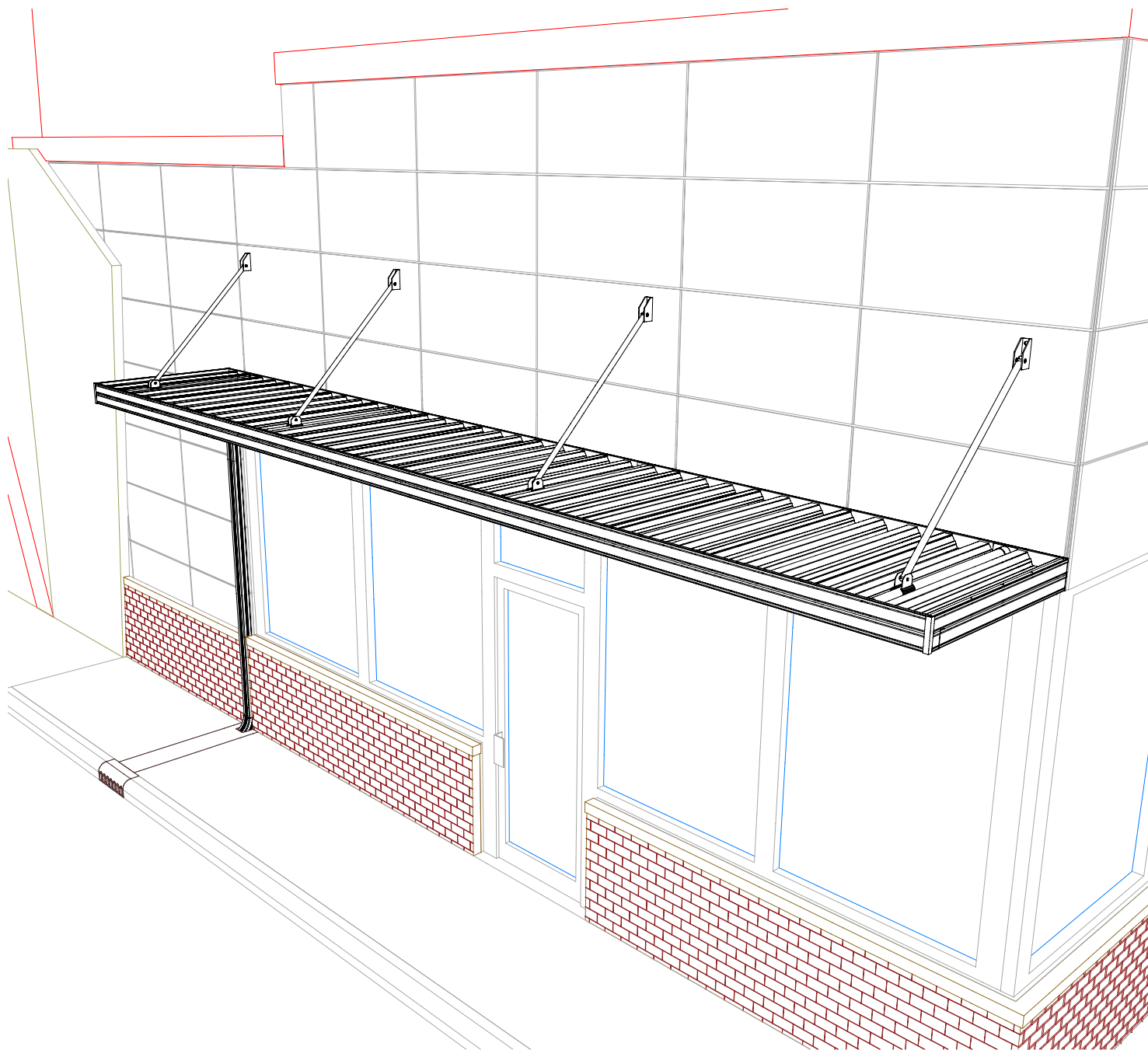

IMPERIAL MARQUEE w/ 24" ROOF PANELS INSTALLATION INSTRUCTIONS



Recommended Tools:

Safety Glasses, Tape Measure, Carpenters Level, Framing Square, Hex Head Nut Drivers, Chalk Line
2 - Ladders, 1 - 2 x 4 Board, Elec. Drill w/ Bits (Masonry Drill, Bits, & Anchors may be required if securing to Stone, Concrete, or any other masonry unit.)

Before You Begin:

- 1.) Please read all instructions carefully. Check the Bill of Materials for any missing parts, and gather necessary tools. To prevent scratching of painted materials, place on a tarp, paper, or protective material.
- 2.) Note that this Patio Cover Kit is not designed to carry additional loads such as hanging heavy plants, swings, people, or other objects.

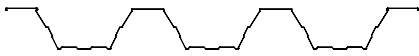

1. 24" Roof Panel

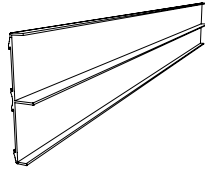

2. Projection Fascia

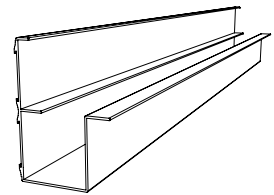

3. Gutter

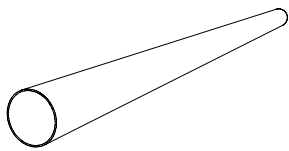

4. 2" dia. Projection Tube

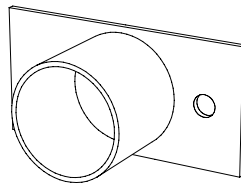

5. Fascia Fitting

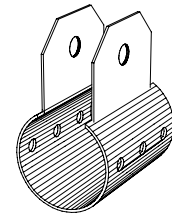

6. Slide Fitting

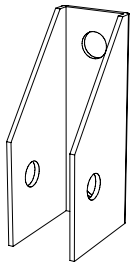

7. Wall Mounting Bracket

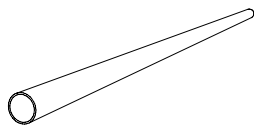

8. 1" dia. Support Tube

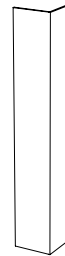

9. Corner Cap

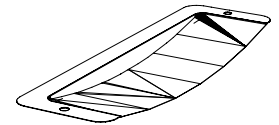

10. Scupper

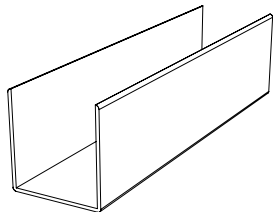

11. Lower Gutter Splice

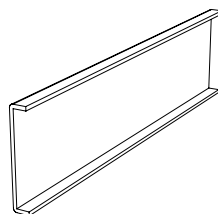

12. Upper Gutter Splice

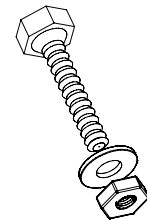

13. 3/8" x 2" Bolt
w/ Nut & Washer



14. #8 x 3/4" Tek Screw

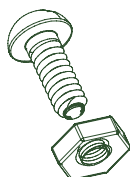

15. 1/4" x 3/4"
Bolt & Nut

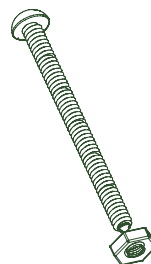

16. 1/4" x 2 1/2"
Bolt & Nut

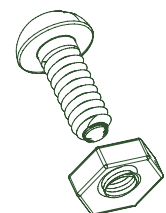

17. 3/8" x 1"
Bolt & Nut

STEP 3

Locate the wall bracket directly above a fascia fitting. To determine the height above the gutter simply subtract 1'-0" from the projection length. (Example: 5'-0" Proj. - 1'-0" = 4'-0" above the gutter, see Fig. 3-1). Secure the wall bracket to structure with 2 anchors able to withstand 800 lbs. tension & 800 lbs. shear each (not included, see Fig. 3-2).

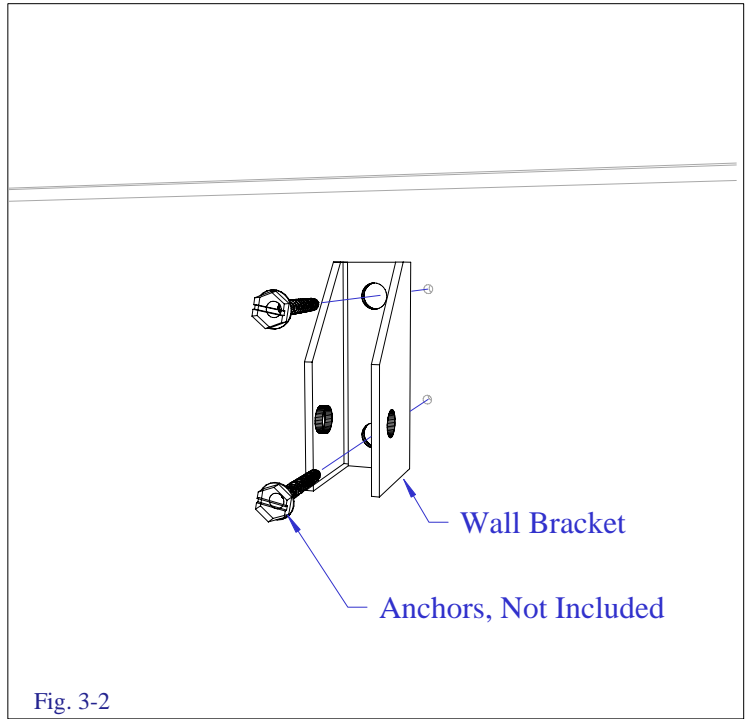
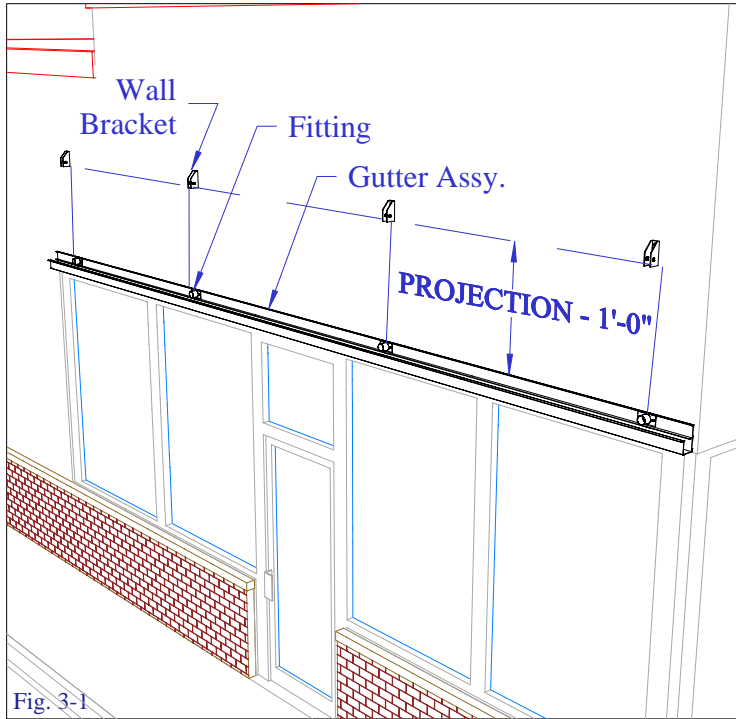

STEP 4

Insert the 2" projection tubes into the fascia fittings (see Fig. 4-1). Slip the slide fitting onto the 2" projection tube (see Fig. 4-2).

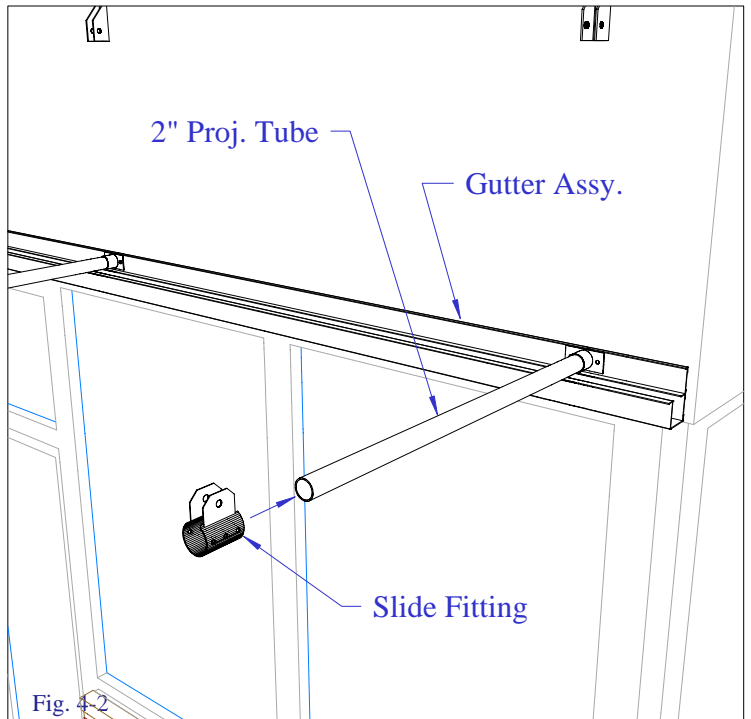
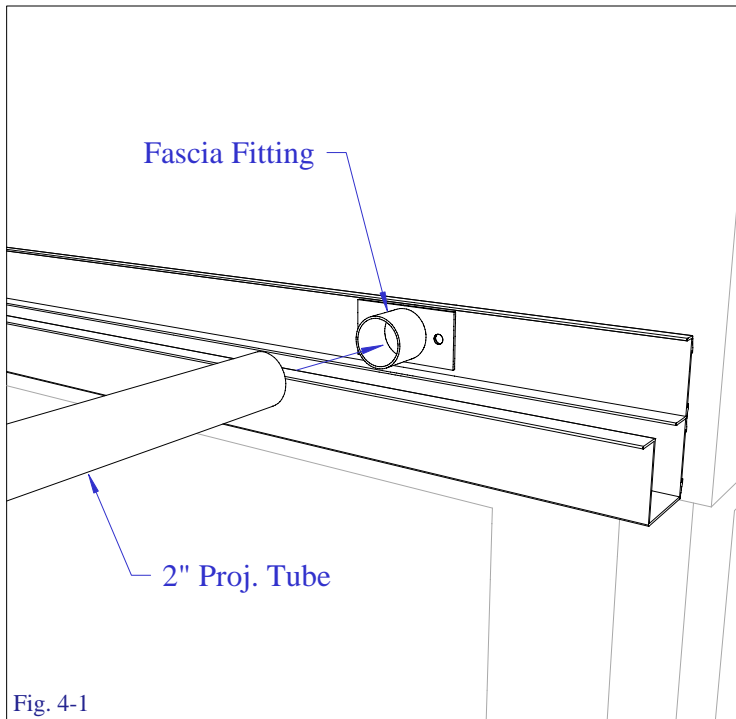

STEP 5

After predrilling parallel sets of 7/16" dia. holes at each end of the support tube, align the 1" support tube between the wall bracket and slide fitting. Anchor the support tube to the slide fitting (see Fig. 5-1) and the support tube to the wall bracket (see Fig. 5-2) using 3/8" x 2" bolts and nuts. NOTE: The slide fitting should be placed at a distance 1'-0" from the front of the shelter creating a 45 deg. angle. Some applications require cutting the 1" support tube for a proper fit.

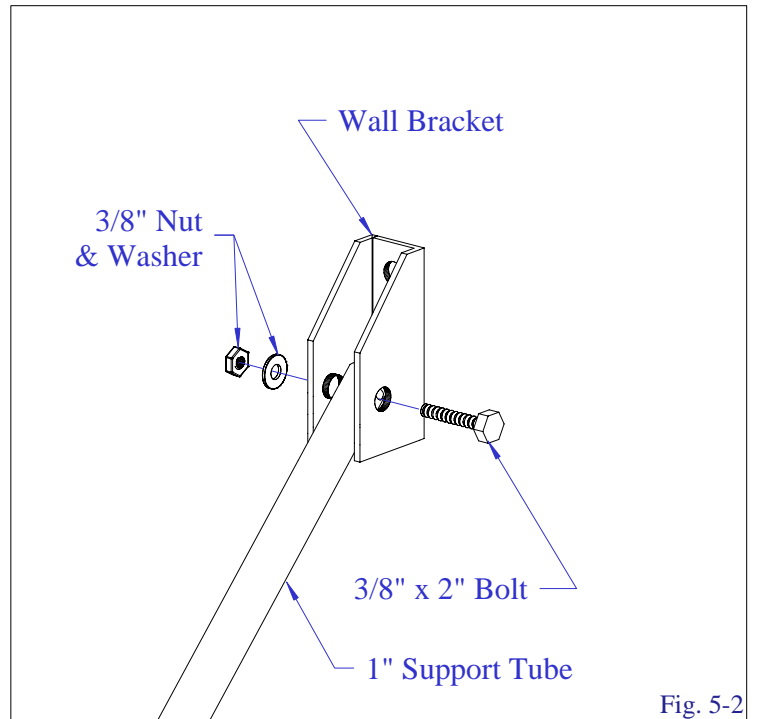
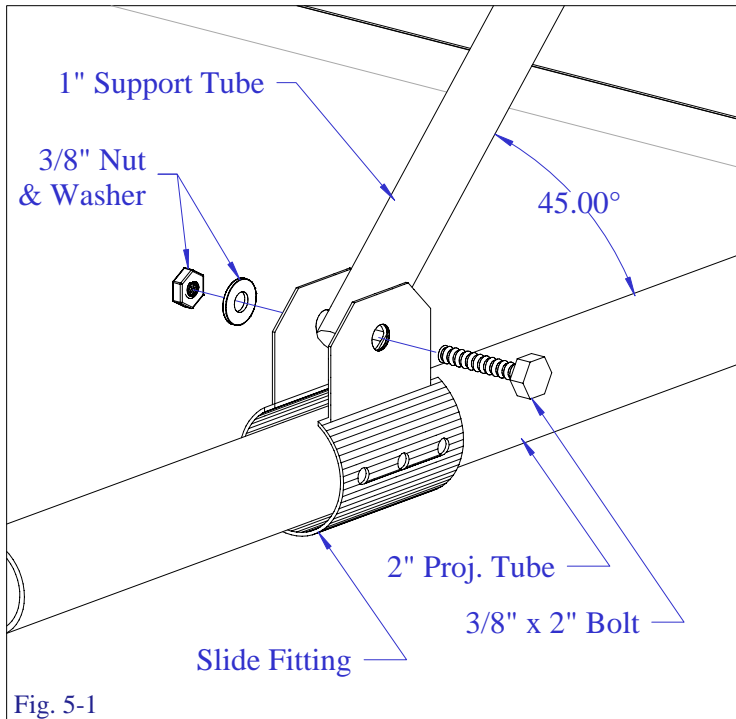

STEP 6

Build a temporary support system to carry the front portion of the roof panels. We recommend 2 ladders and a 2x4 the same length as your shelter width. Place one end of the roof panels into the wall gutter and the other end over the temporary beam (see Fig. 6-1). Secure the roof panels to the wall gutter using 2 - #8 x 3/4" Tek Screws per panel (see Fig. 6-2).

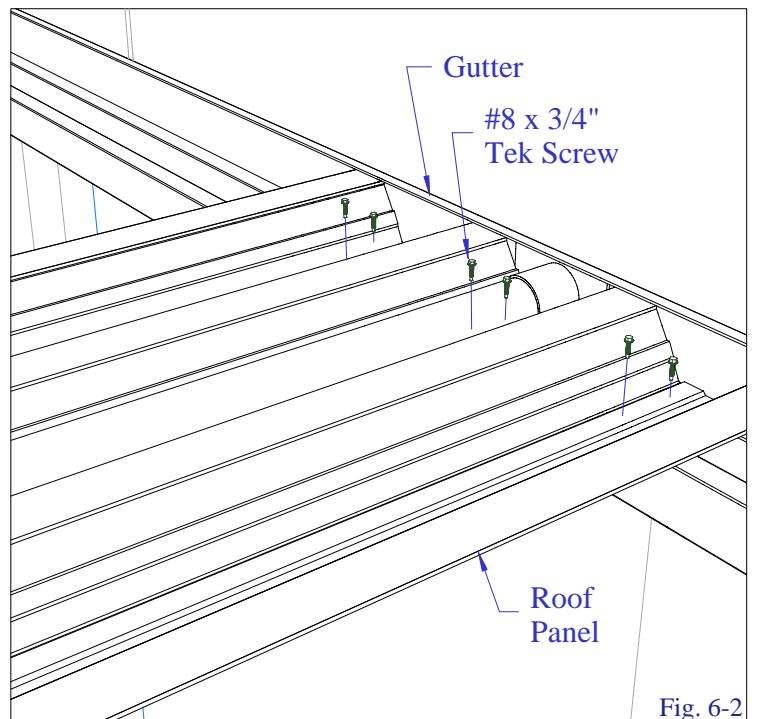
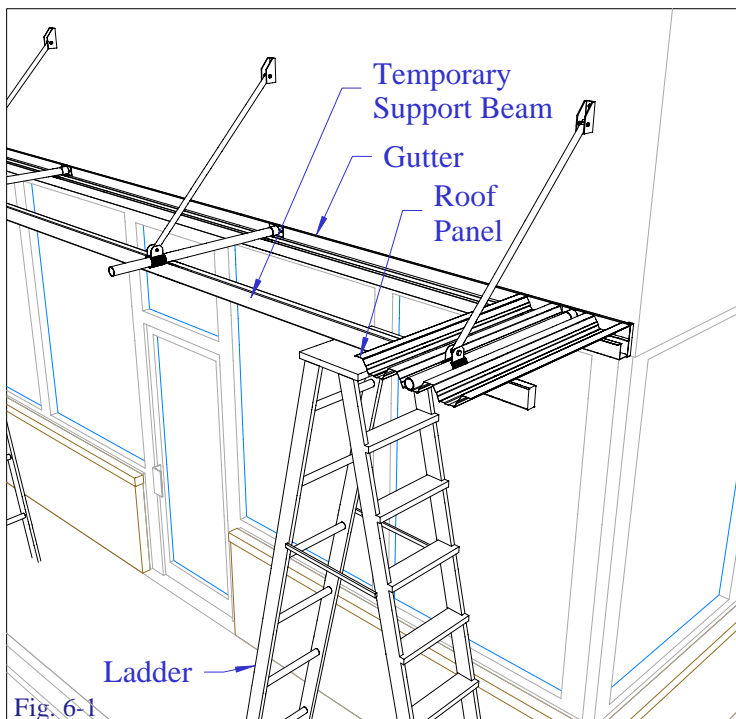

STEP 7

Hoist the gutter into position being sure to align the fascia fittings with the proj. tube and hold in position (see Fig. 7-1). Secure the roof panels to the gutter using 2 - #8 x 3/4" Tek Screws per panel (see Fig. 7-2).

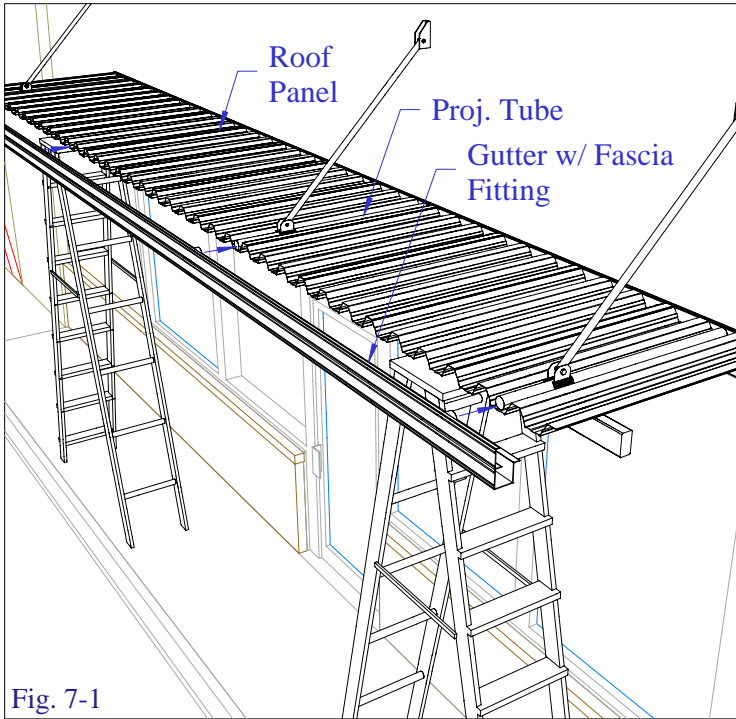

Fig. 7-1

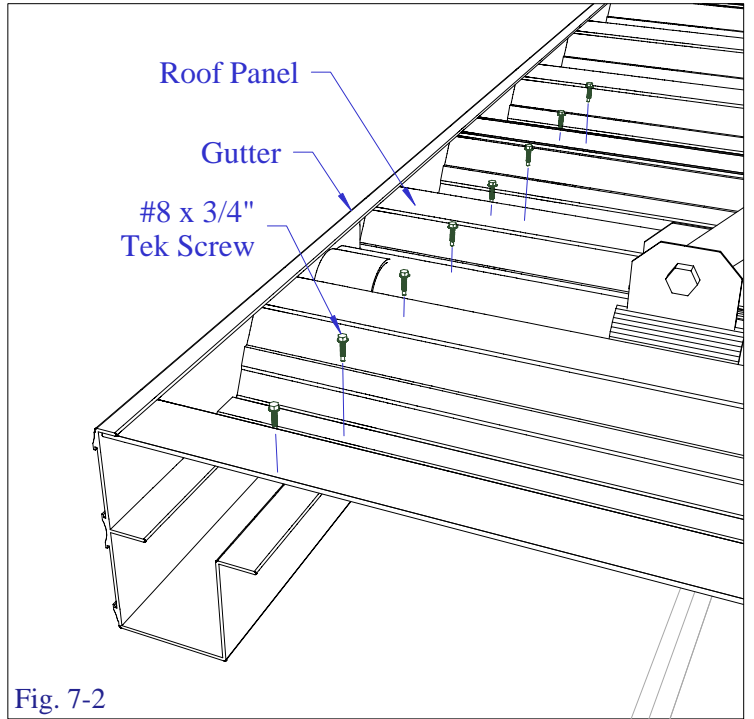

Fig. 7-2

STEP 8

Slide one gutter fascia between the corner cap and gutter (see Fig. 8-1). Locate the front corner cap and fasten both caps to the projection fascia/gutter using 4 - #8 x 3/4" Tek Screws per cap (see Fig. 8-2). Be sure to caulk between the corner cap & fascia/gutter before securing.

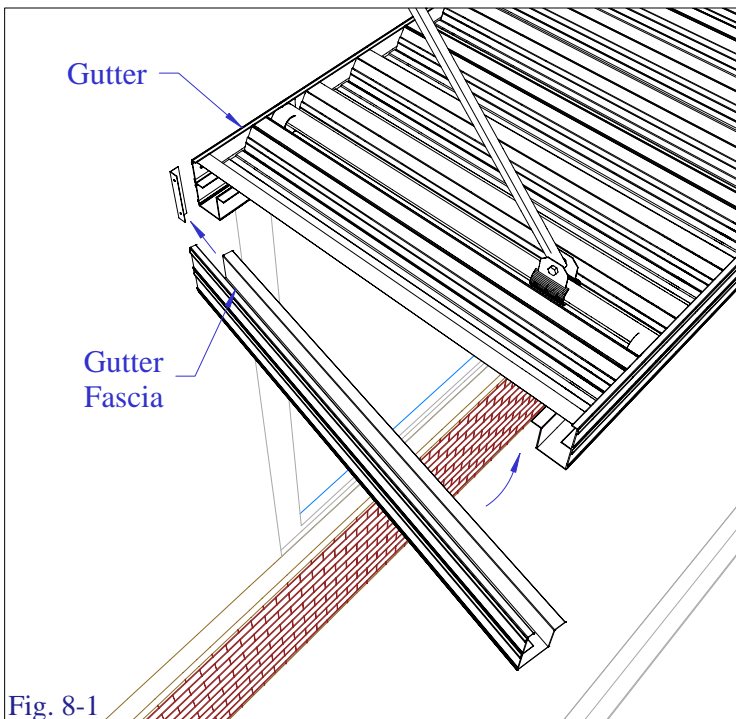

Fig. 8-1

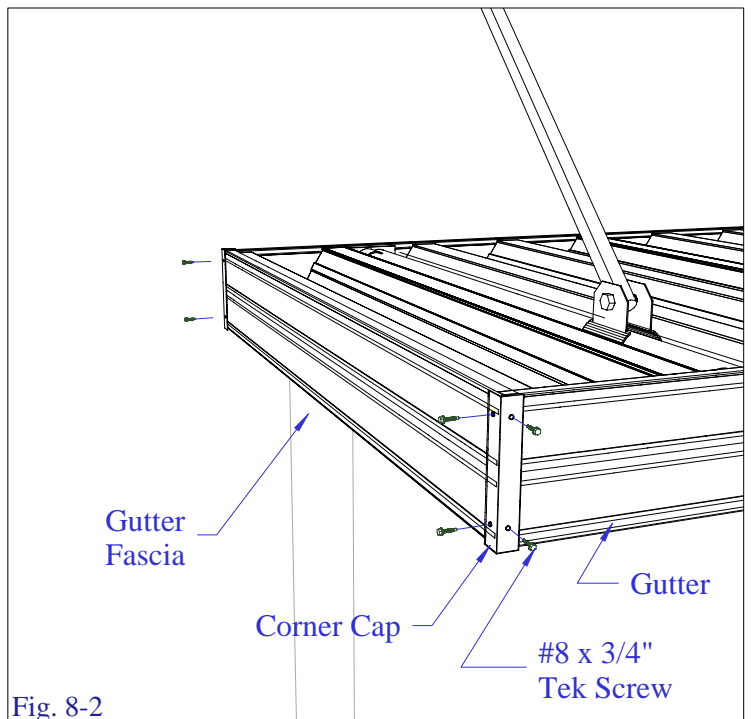
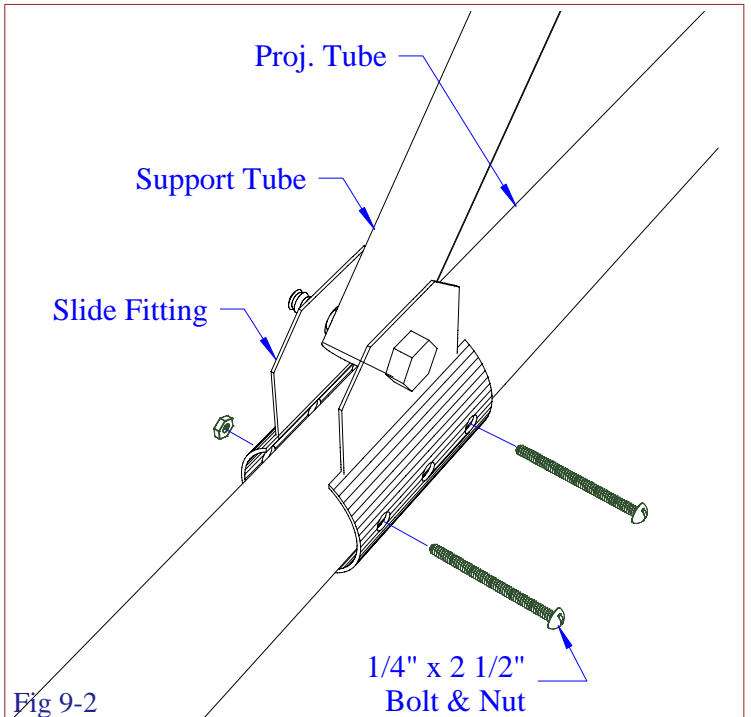
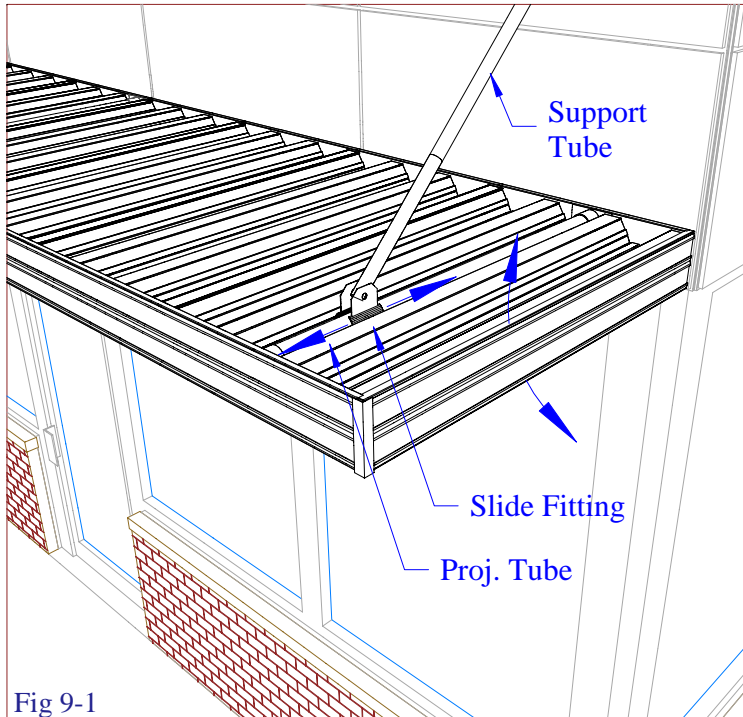

Fig. 8-2

STEP 9

Work the slide fitting backward or forward to level or achieve the desired pitch (see Fig 9-1) depending on which gutter is chosen to drain rain water. Once properly located, anchor the slide fitting to the 2" projection tube using 3 - 1/4" x 2 1/2" Bolts & nuts (see Fig. 9-2)



STEP 10

Drill numerous holes in a 2" x 3" pattern in the end of one of the gutters to relieve rain water run-off. Apply caulking to lip of scupper that faces gutter. Attach the scupper over the pattern of holes using 2 - #8 x 3/4" Tek Screws (see Fig 10-1).

